

## Roller Mower

### Belt Adjustment

The two belts are adjusted independently as follows:

- Slacken locknut **1** only sufficient enough to allow the pulley to move in the slot.
- Back off locknut **2**.
- Tension belt by adjustment of nut **3** to correct deflection – *see note below*.
- Re-tighten all locking nuts, and re-check belt tension.

#### NOTE:

It is important to pull the belt 'around' by hand as it is being tensioned to allow the belt to 'creep' on the drive pulley – tightening the belt without pulling it round will over tension the belt between drive and centre pulley causing premature failure of the belt.

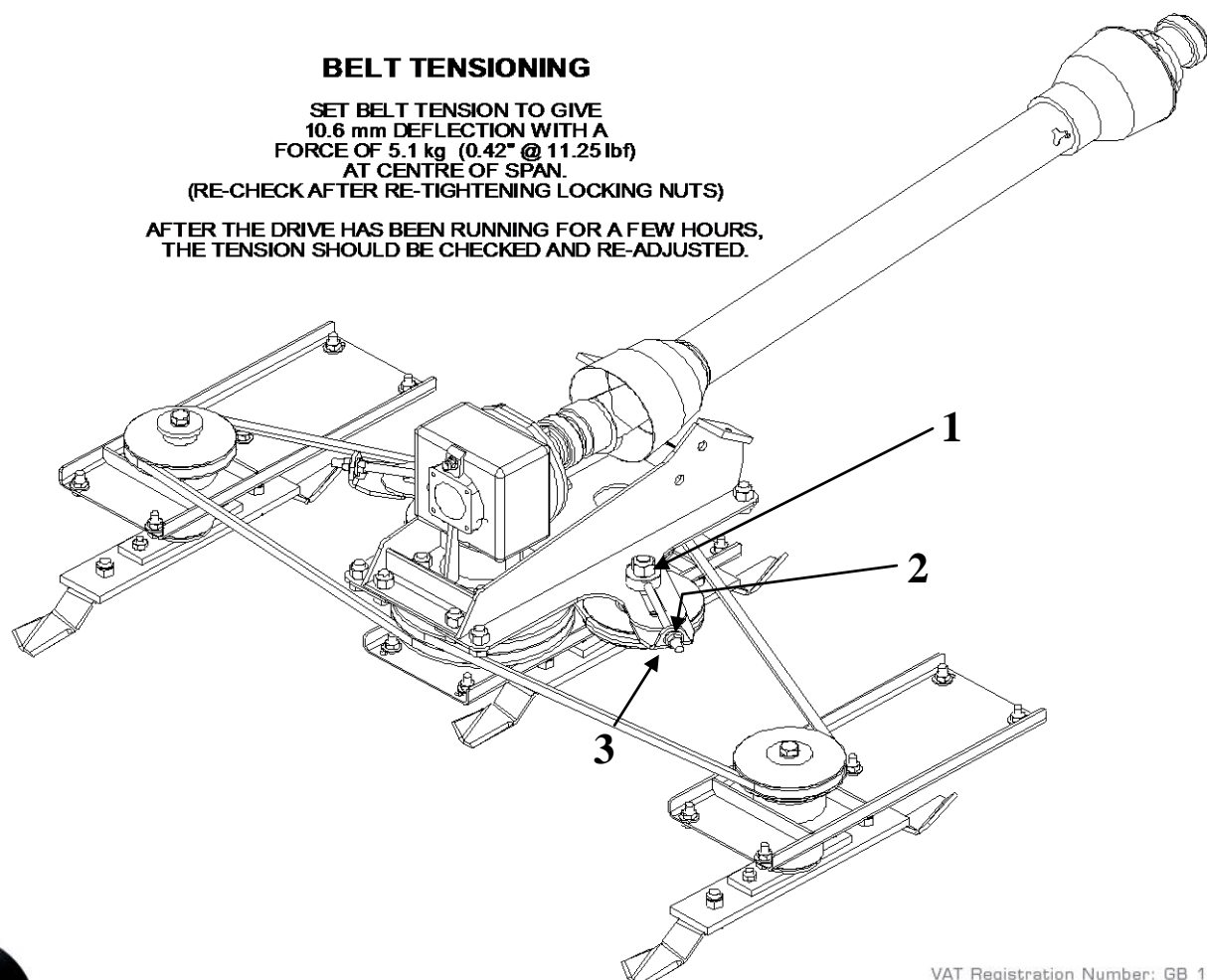

#### BELT TENSIONING

SET BELT TENSION TO GIVE  
10.6 mm DEFLECTION WITH A  
FORCE OF 5.1 kg (0.42" @ 11.25 lbf)  
AT CENTRE OF SPAN.

(RE-CHECK AFTER RE-TIGHTENING LOCKING NUTS)

AFTER THE DRIVE HAS BEEN RUNNING FOR A FEW HOURS,  
THE TENSION SHOULD BE CHECKED AND RE-ADJUSTED.

