

SUPERCUT ROTOR HUB REPAIR

Early supercut rotors were only splined at one end, later ones were splined at both ends so they could be turned round when the first spline wore out.

A 6 spline weld in drive hub kit, part number 7191605, is available to repair these rotors. It includes the coupling, part number 7191391, shown below, but not the 6 spline drive coupling, part number 7190573 (sold as 7190580 coupling and grease)

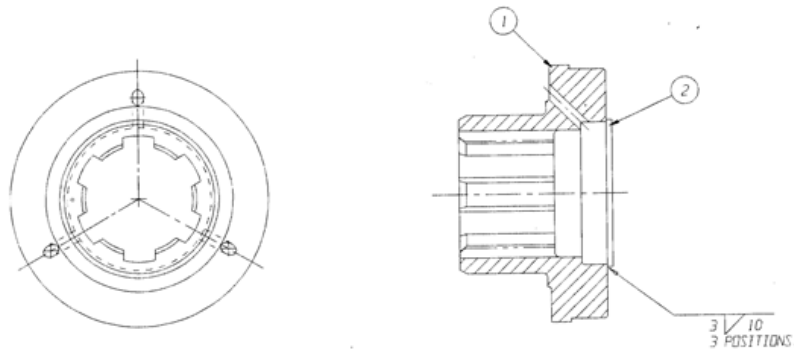

7191391

Rotor spigot alignment- Rotor Hub repair kit 7191605

It is most important that the following procedure is adhered to.

Rotor shaft failure is usually attributed to misalignment caused by distortion of the flail head. When replacing the weld in hubs the end spigots should be machined, as per the drawing below, ensuring the spigots are concentric to each other to within 0.05mm TIR and the rotor tube is concentric to the spigots, maximum eccentricity anywhere in length 0.5mm TIR.

